

# DIAGNOSTIC DESIGN

Final Design Review

# Overview

- Materials
  - 316 stainless steel
  - PPPL will silver plate all screws
- Secure Screws
  - Spot-welding SS wire
  - Slotted coverplates
- Diagnostic Design
  - Physical barriers
  - Rotation capabilities

# Diagnostic in Bay K

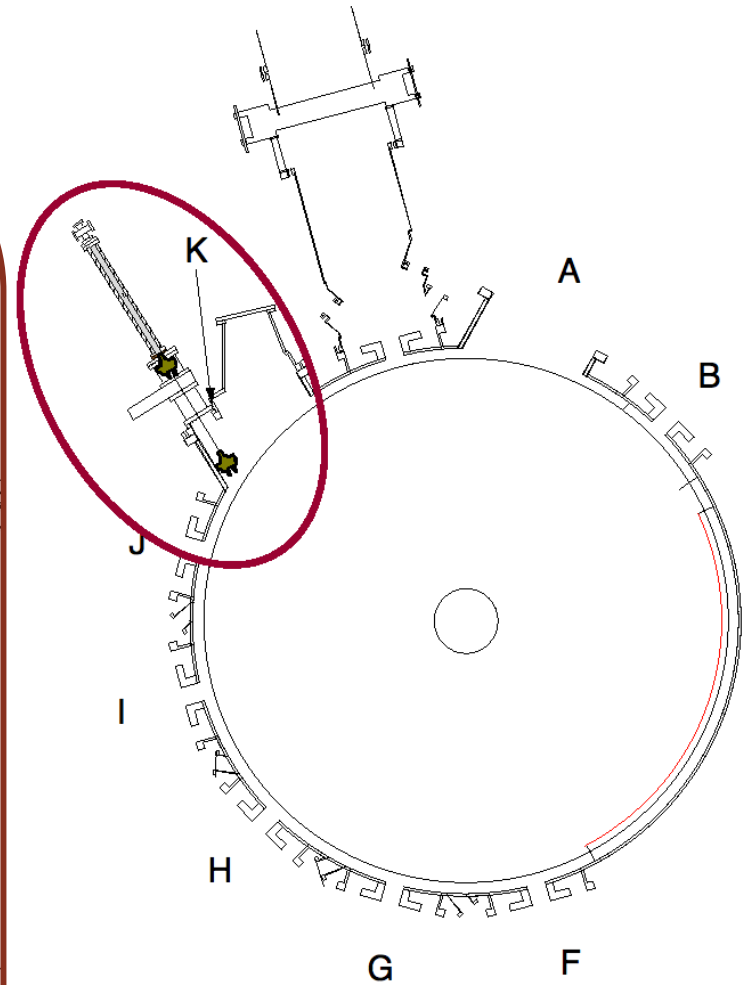
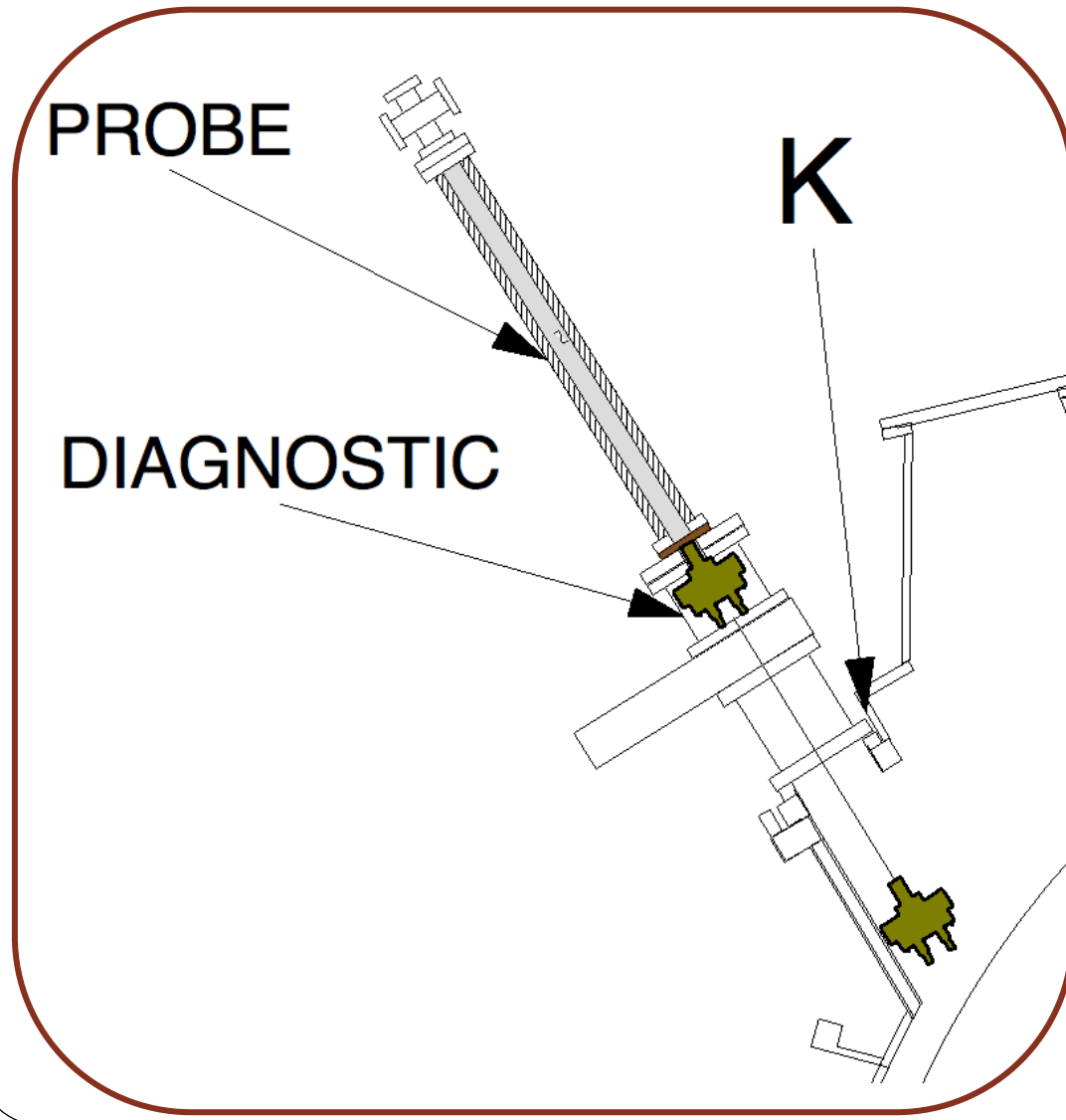

# Total Assembled View

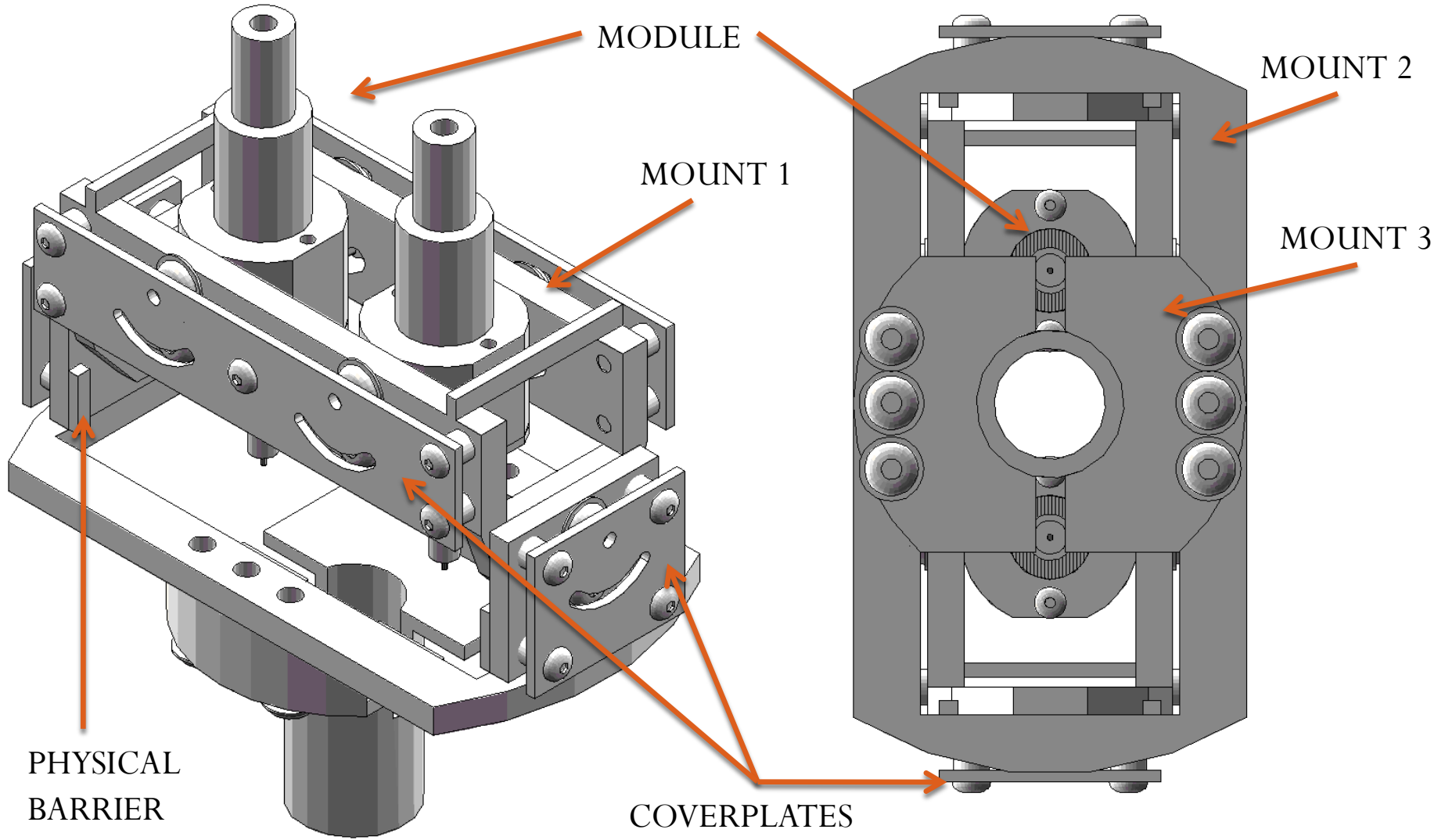

# Total Assembled View

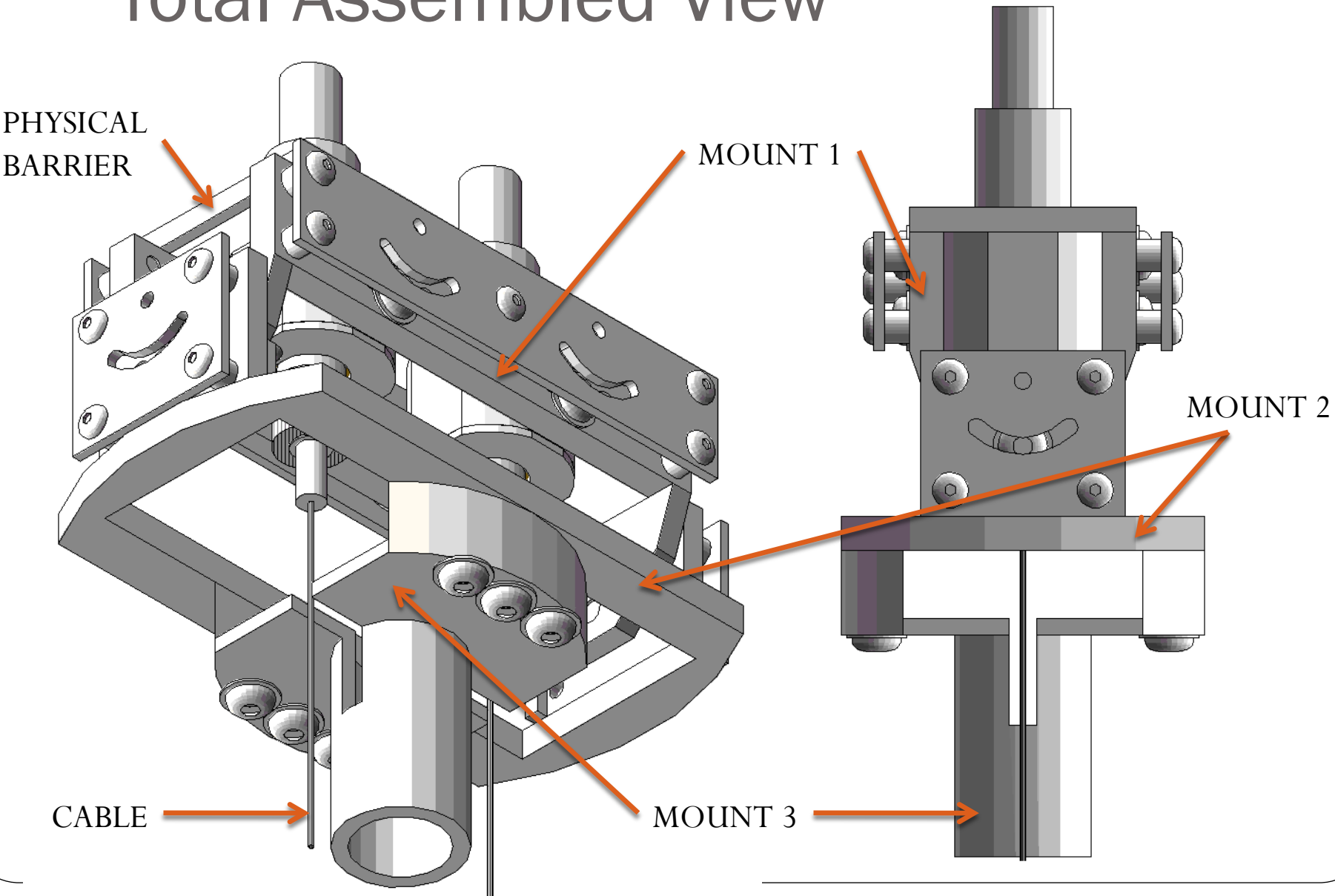

# Total Assembled Dimensions

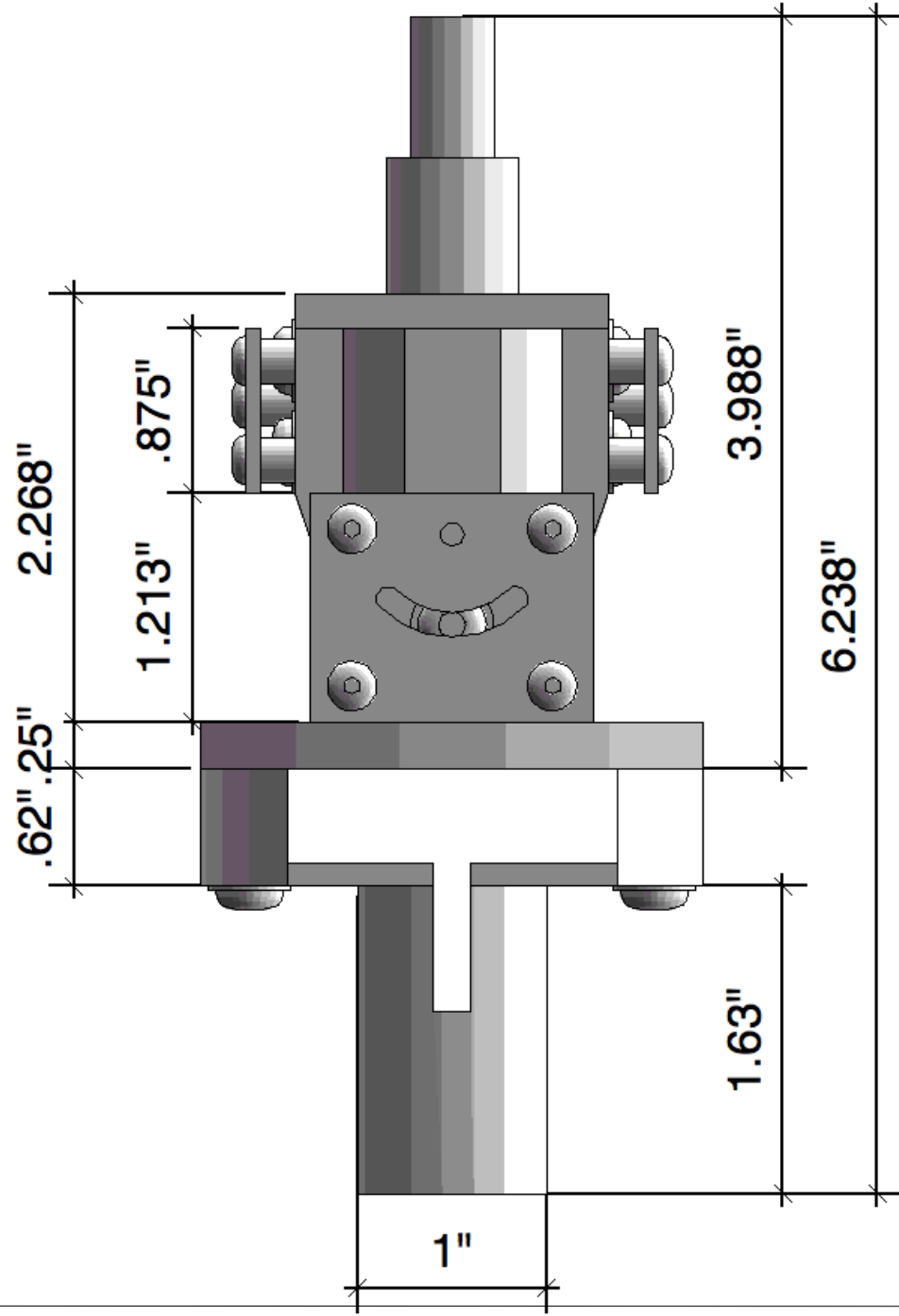

# Total Assembled Dimensions

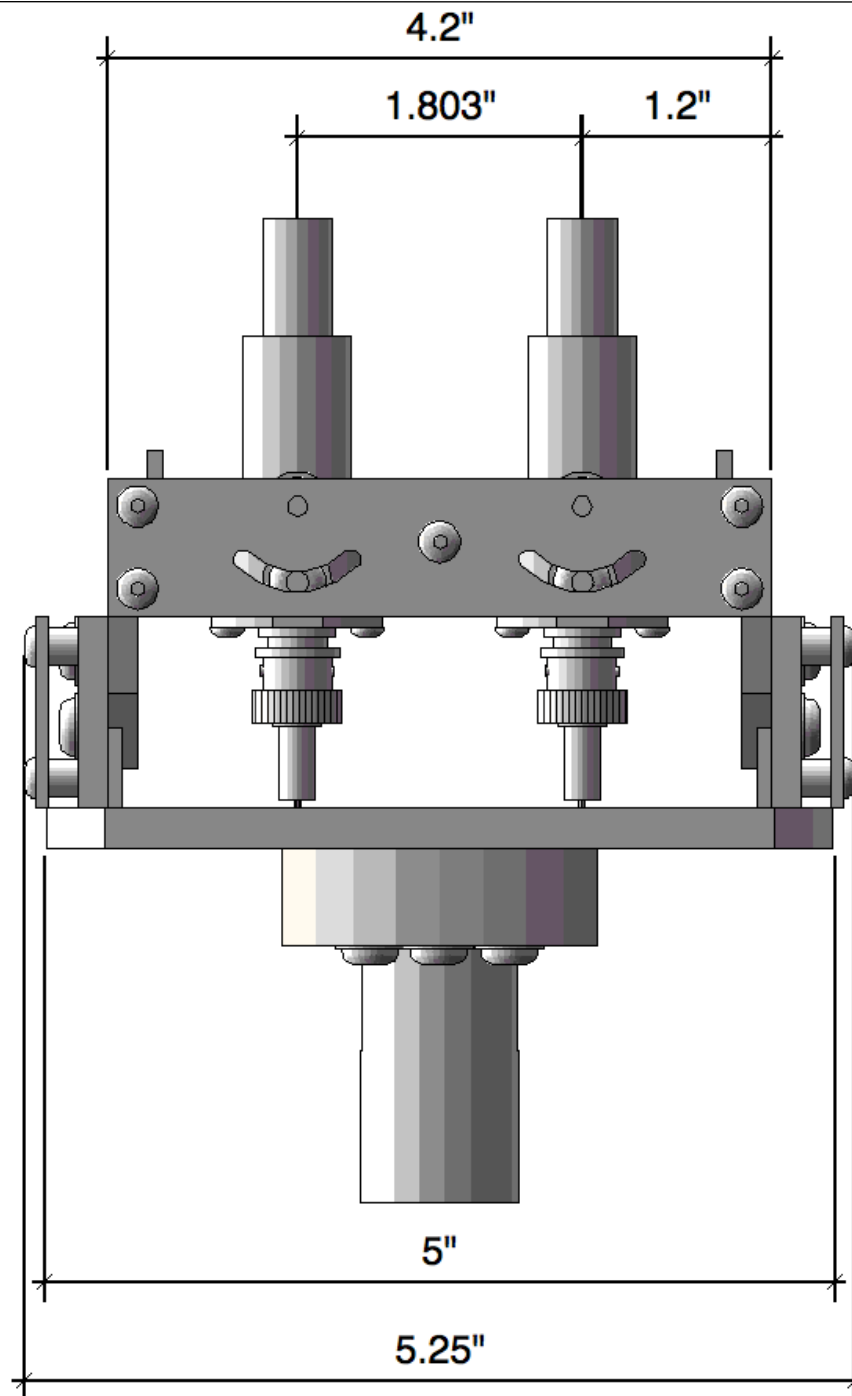

# Mounts

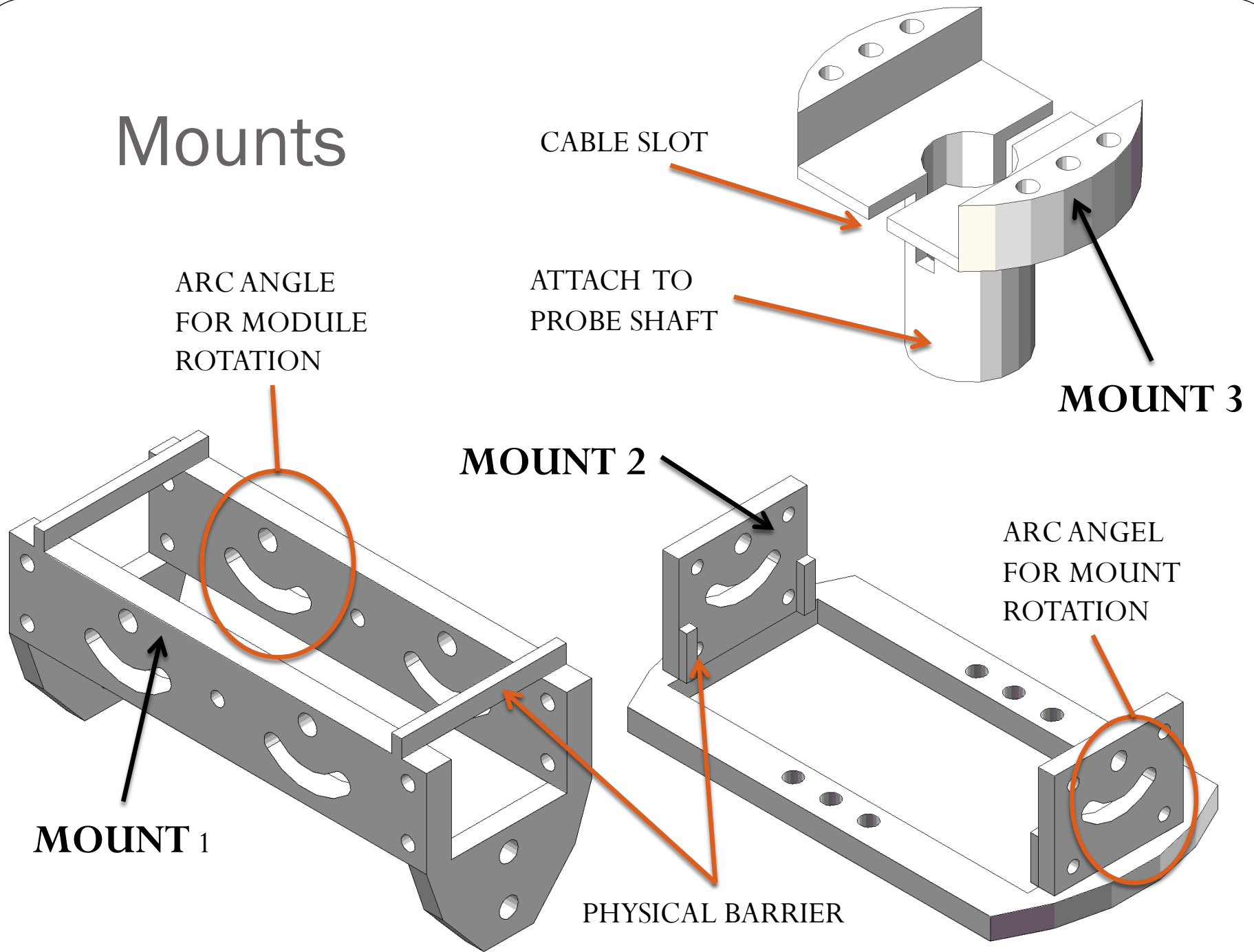



# Module Assembled View

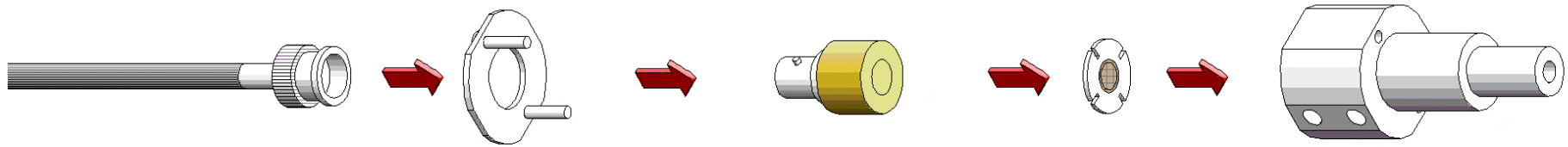

Cable

Base

Detector

Washer

Module

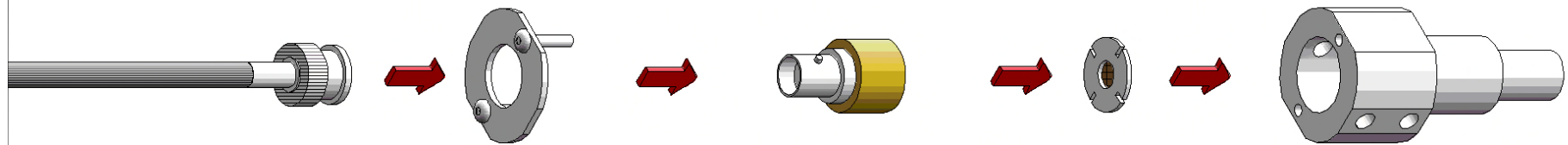

# Module Dimensions

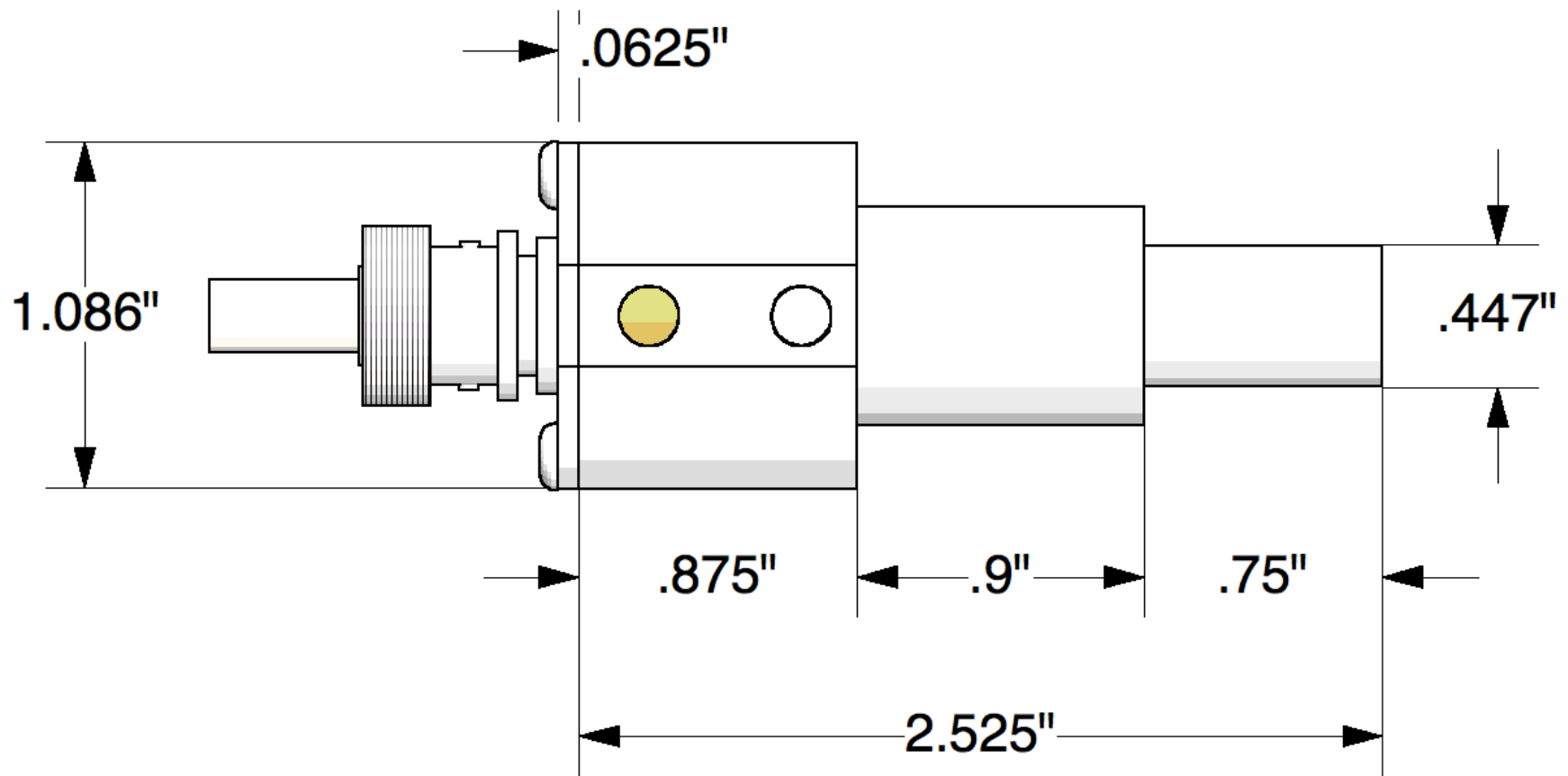

# Module Cross-section

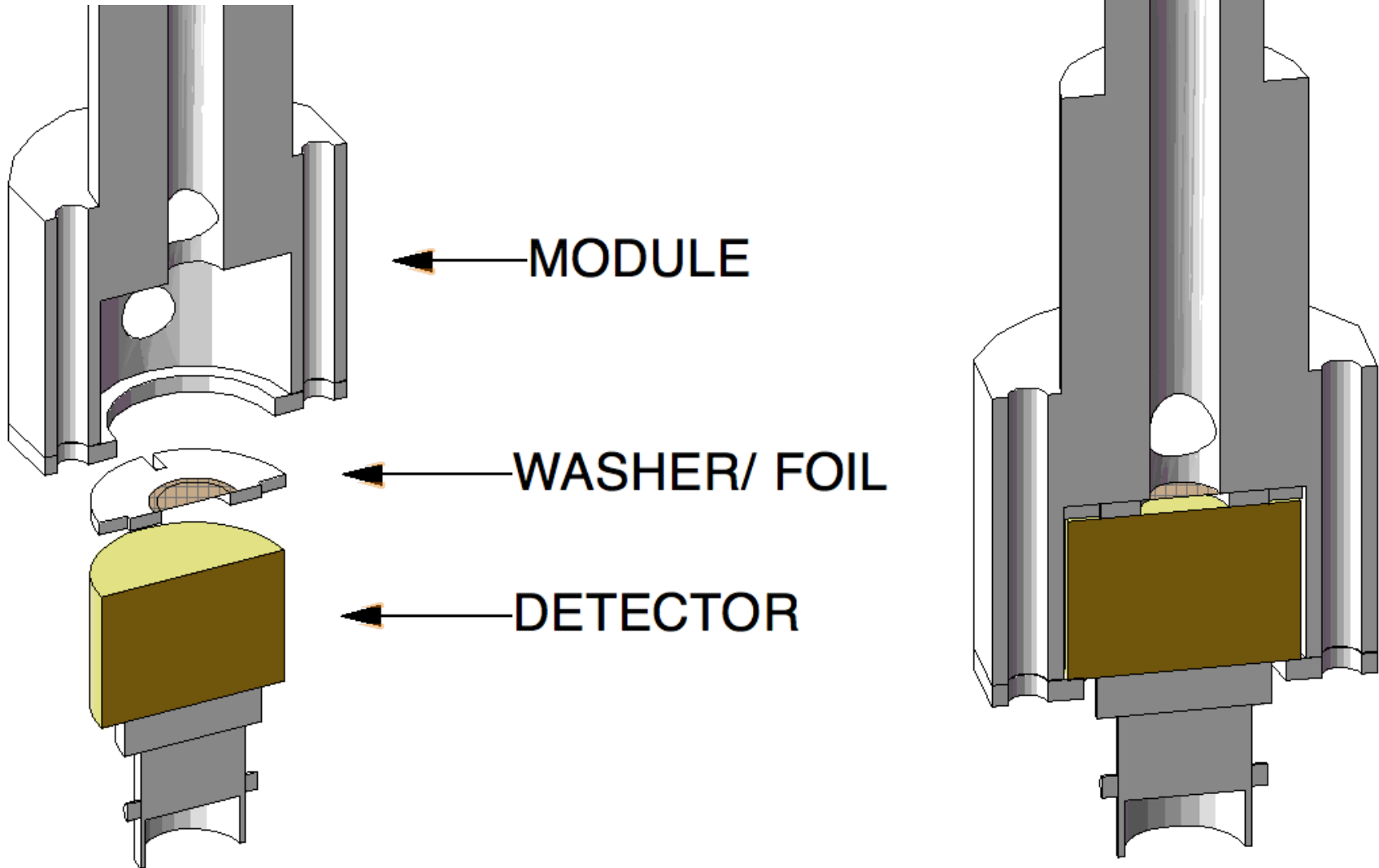

# Module Barrier

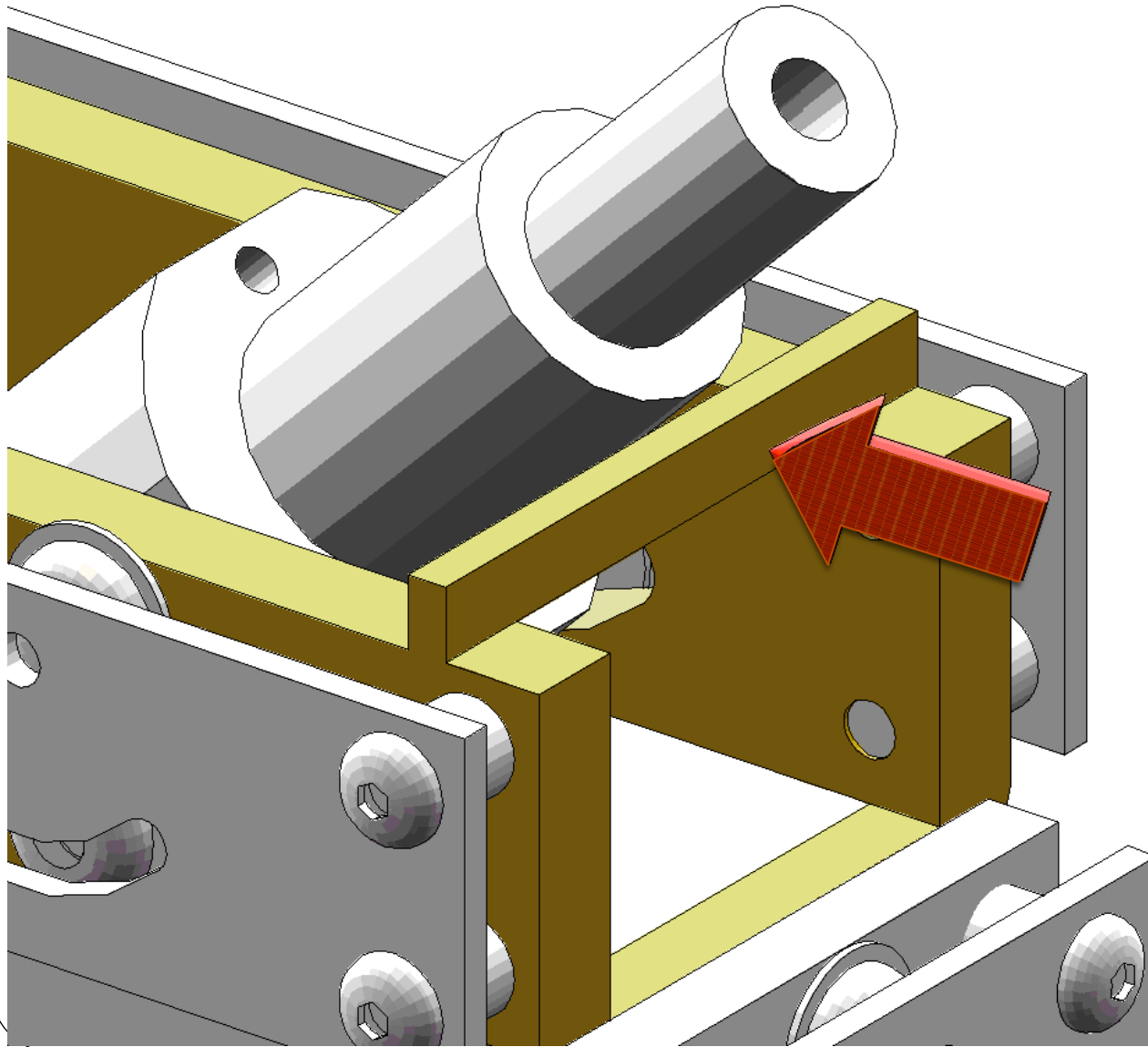

- Physical barrier prevents module from hitting walls of Bay K

# Module Barrier

- Module will stay well within a 5.5 inch diameter due to Physical Barrier
- Prevents module from rotating too far

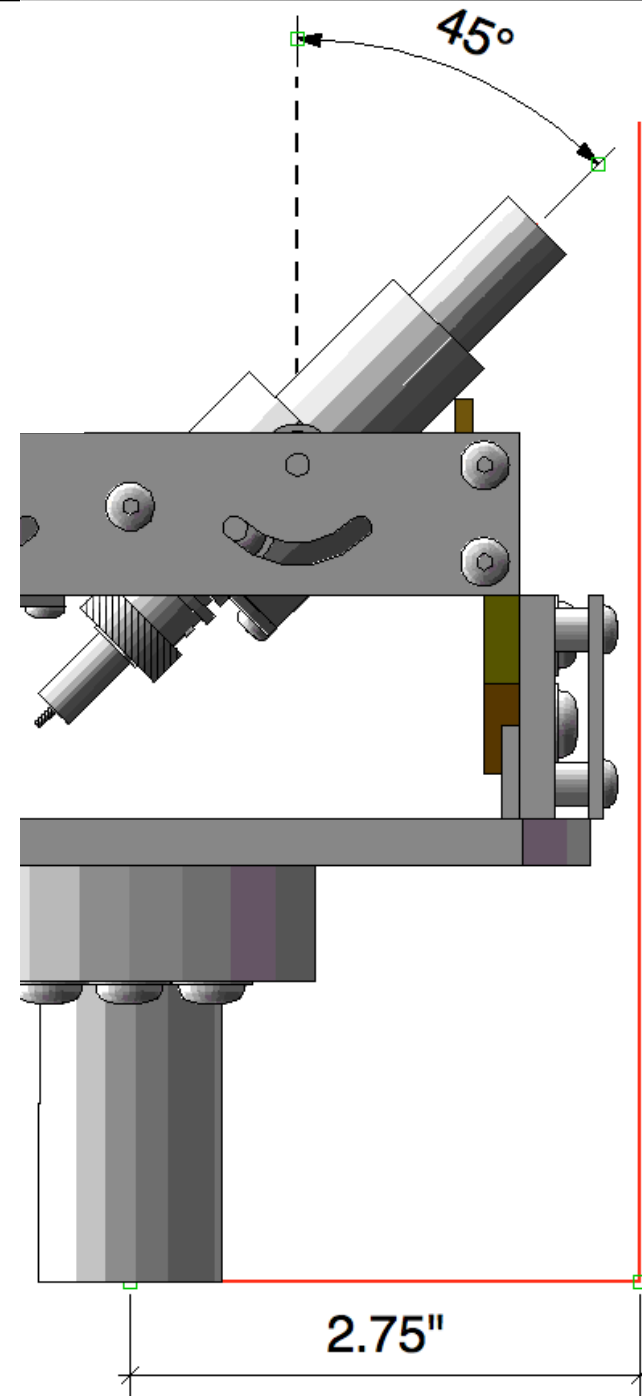

# Mount 1 Barrier

- Physical barrier prevents diagnostic from hitting walls of Bay K

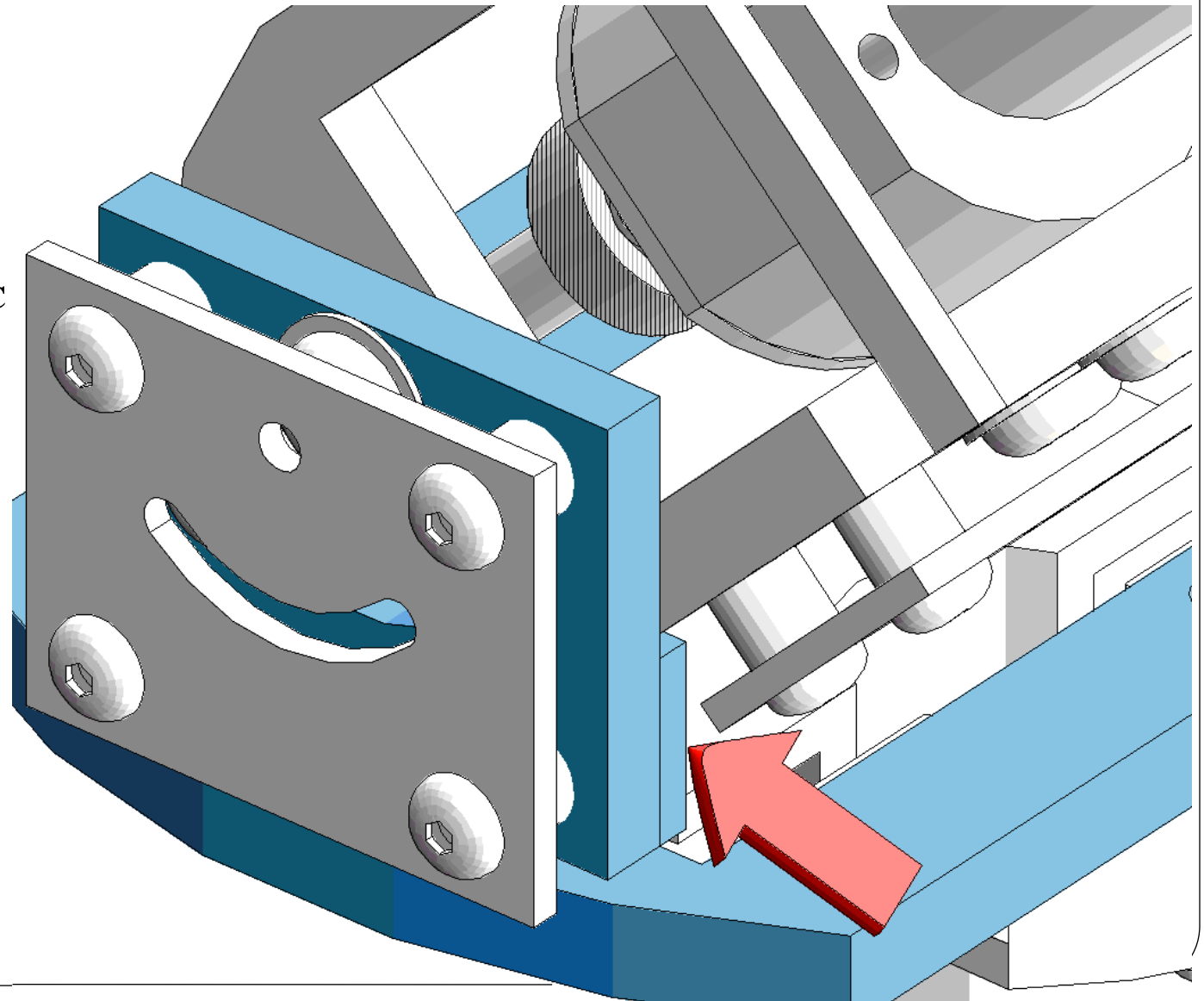

# Mount 1 Barrier

- Diagnostic will stay well within a 5.5 inch diameter due to Physical Barrier.
- Prevents diagnostic from rotating too far

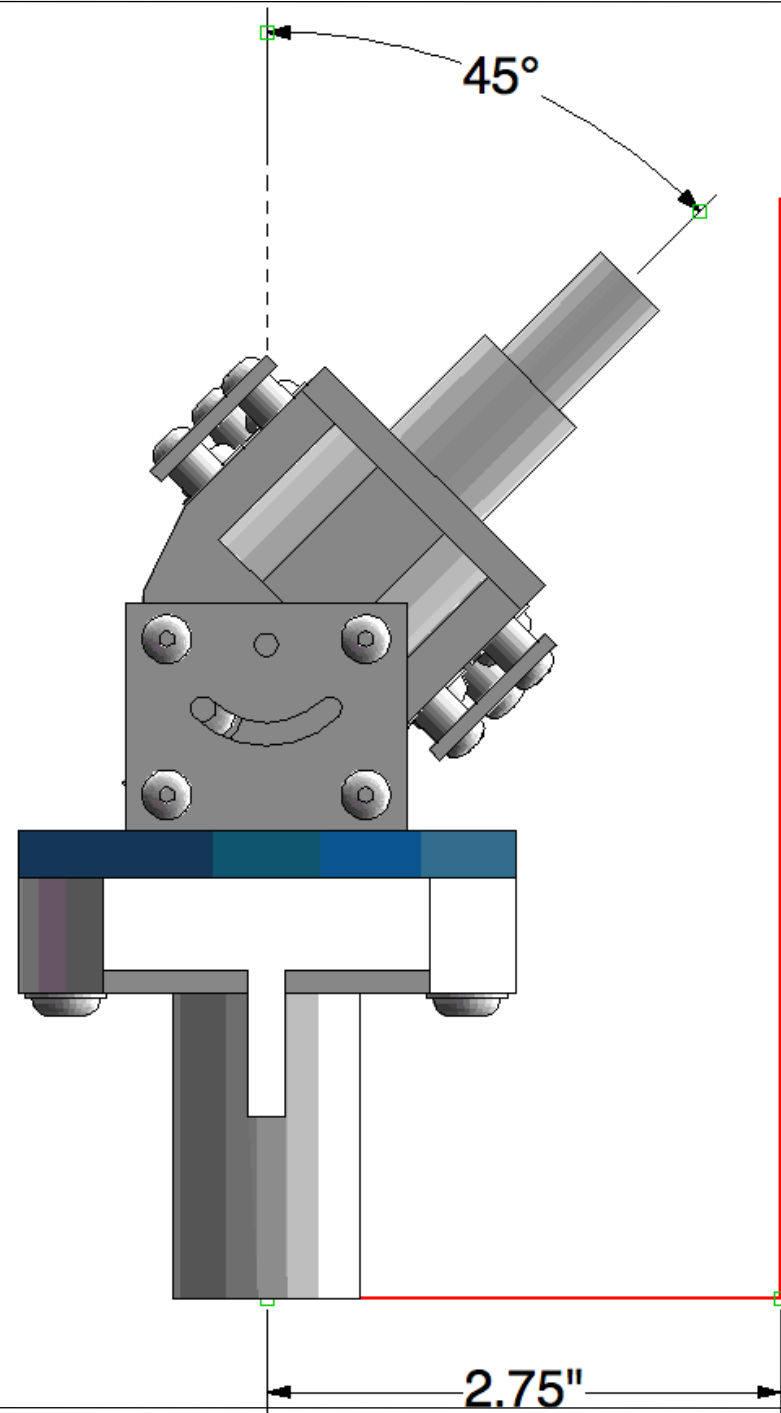

# Coverplates Assembled View

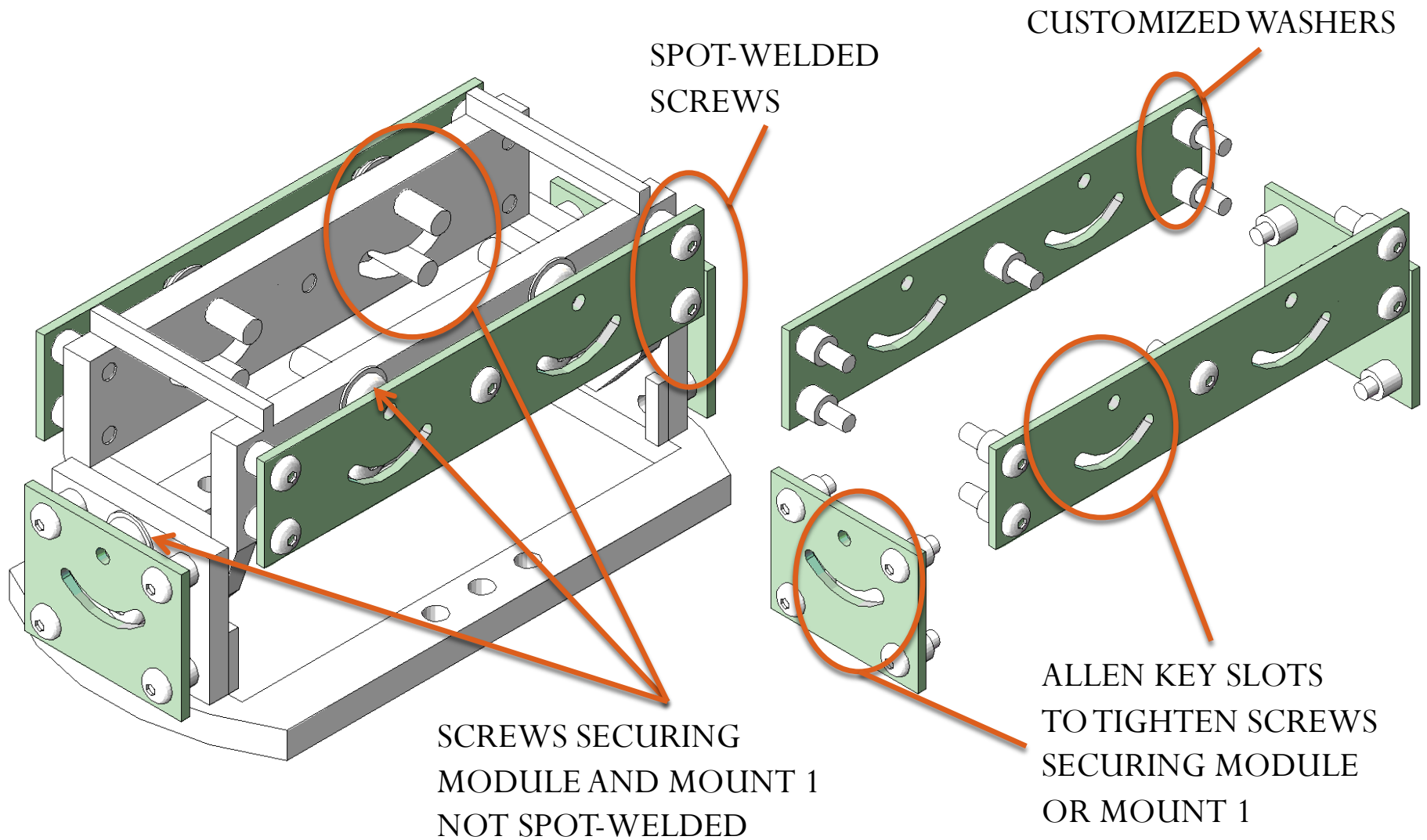



# Coverplates

- Practical for changing module and mount rotation angle
- Holes are large enough for an Allen Key to fit, but not for the socket cap screw head to fall out
- Screws securing coverplates are spot-welded

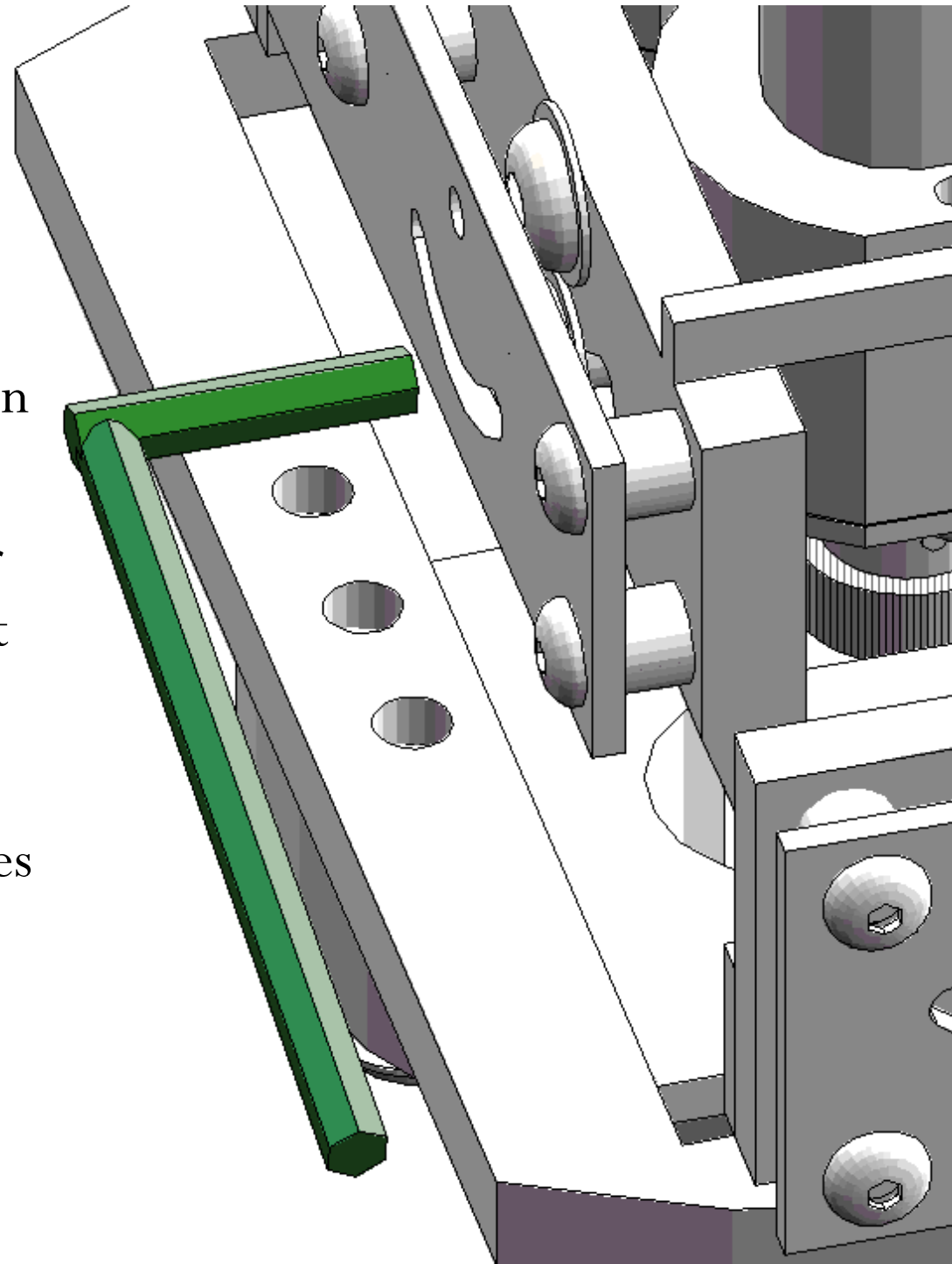

# Coverplates

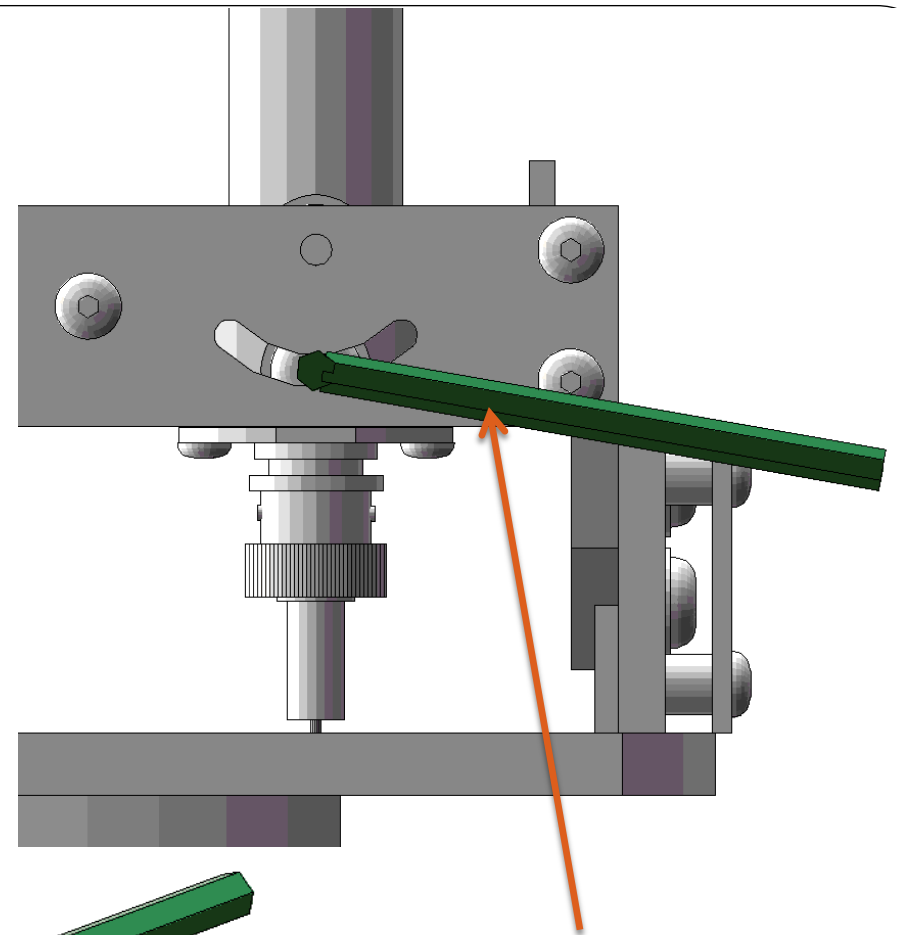
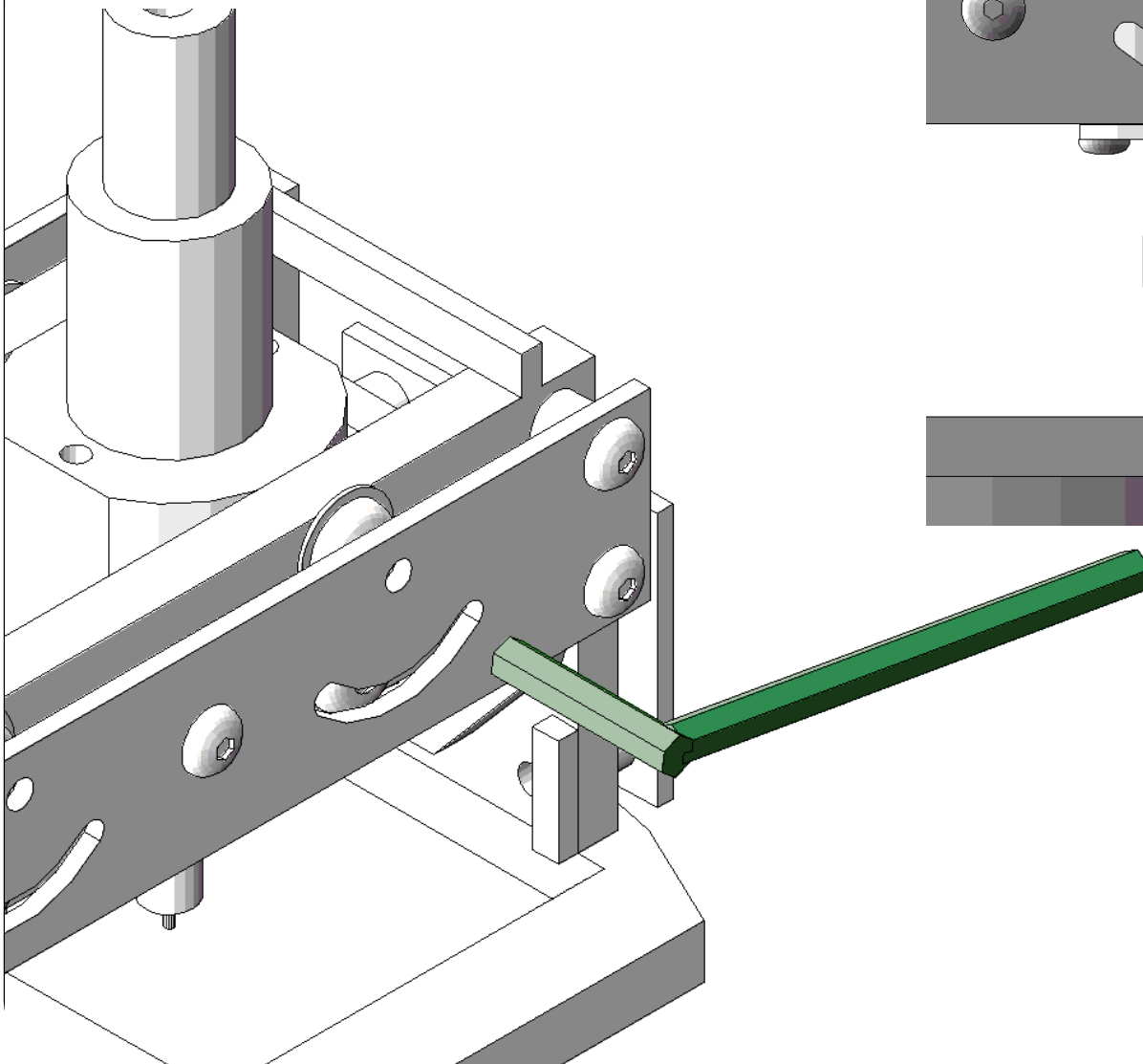

NOTE THAT SLOTS ON COVERPLATES ARE MADE SUCH THAT THE APPROPRIATE ALLEN KEY CAN REACH THE SOCKET CAP SCREW BEHIND THE COVERPLATE

# Angleblocks

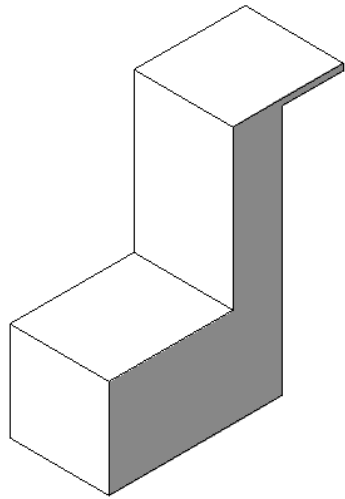

43° Angle block  
for Mount

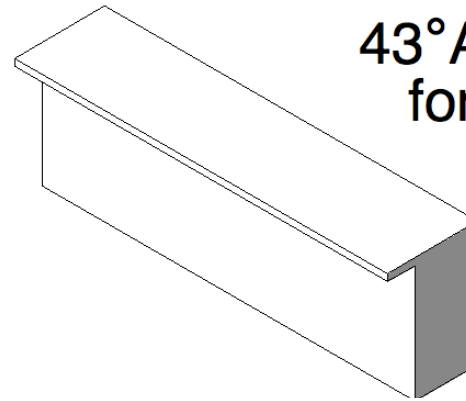

43° Angleblock  
for Module

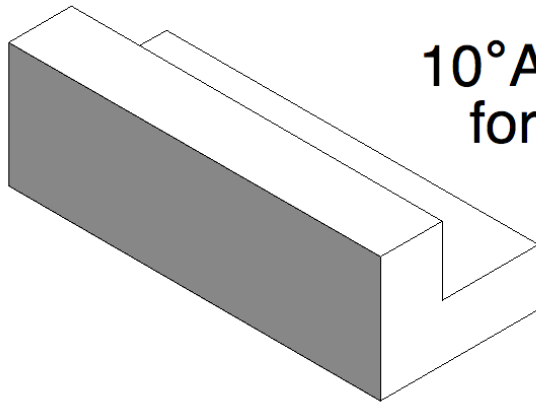

10° Angleblock  
for Module

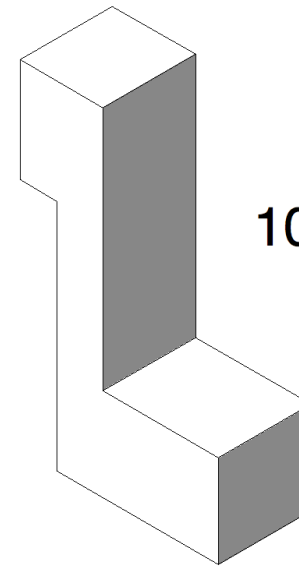

10° Angleblock  
for Mount

# Module Rotation Range

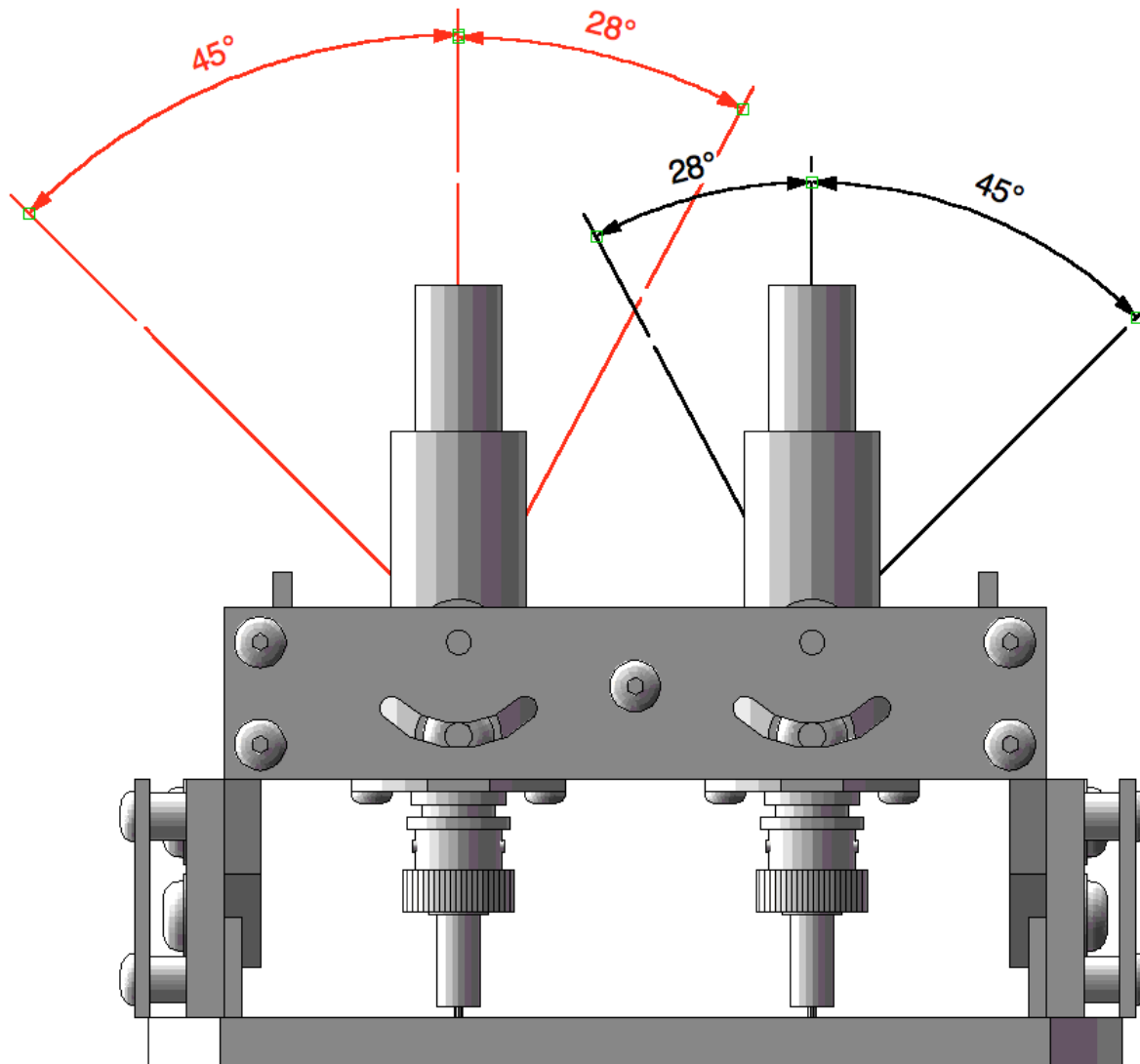

# Module Rotation

- Angleblock is secured to physical barrier on mount with clamp
- Allen key is then used to loosen module so it can rest against angleblock (here 10 degrees)
- Allen key is used to secure module
- Clamp is removed and angleblock slides out

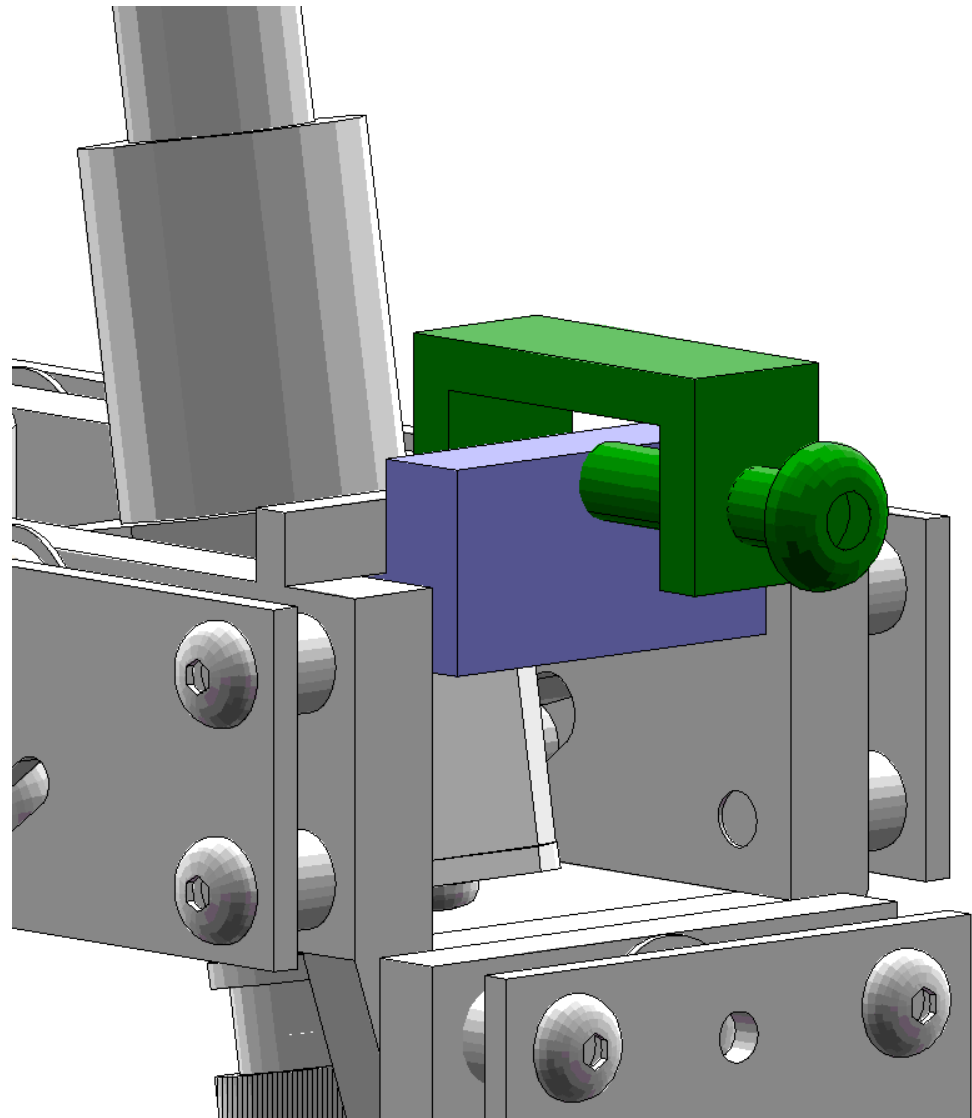

# Module Rotation 10 Degrees

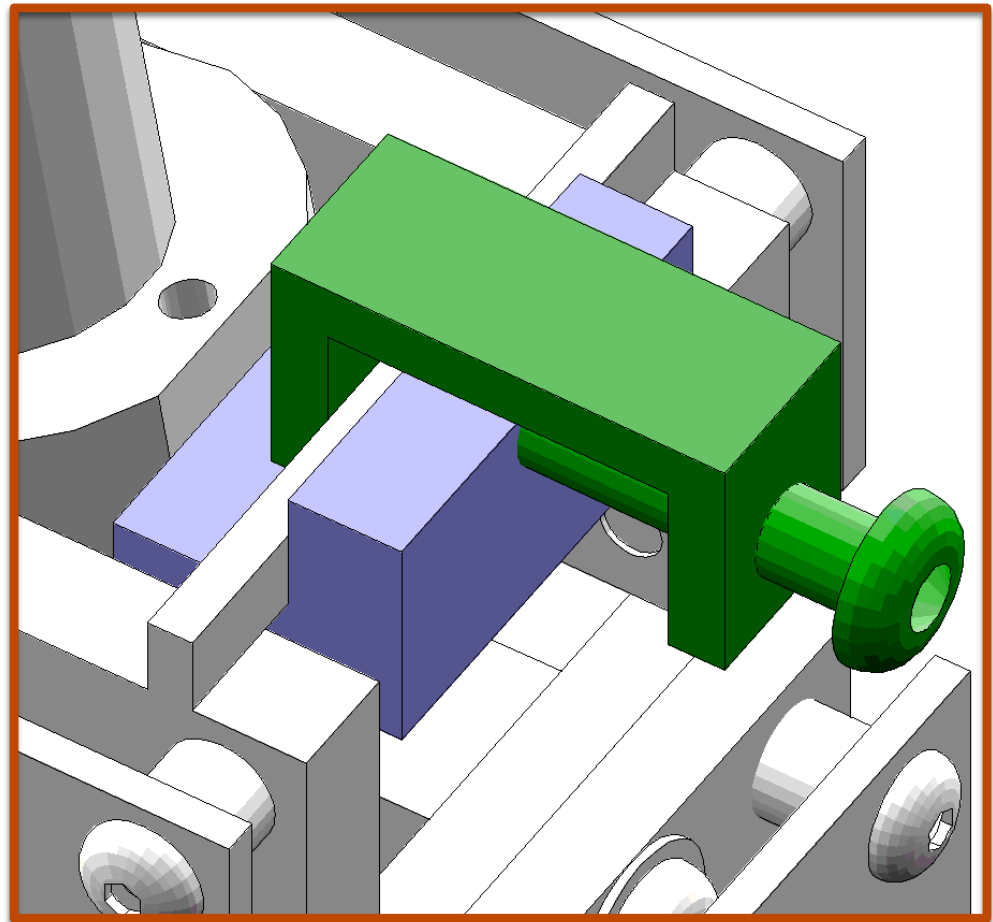
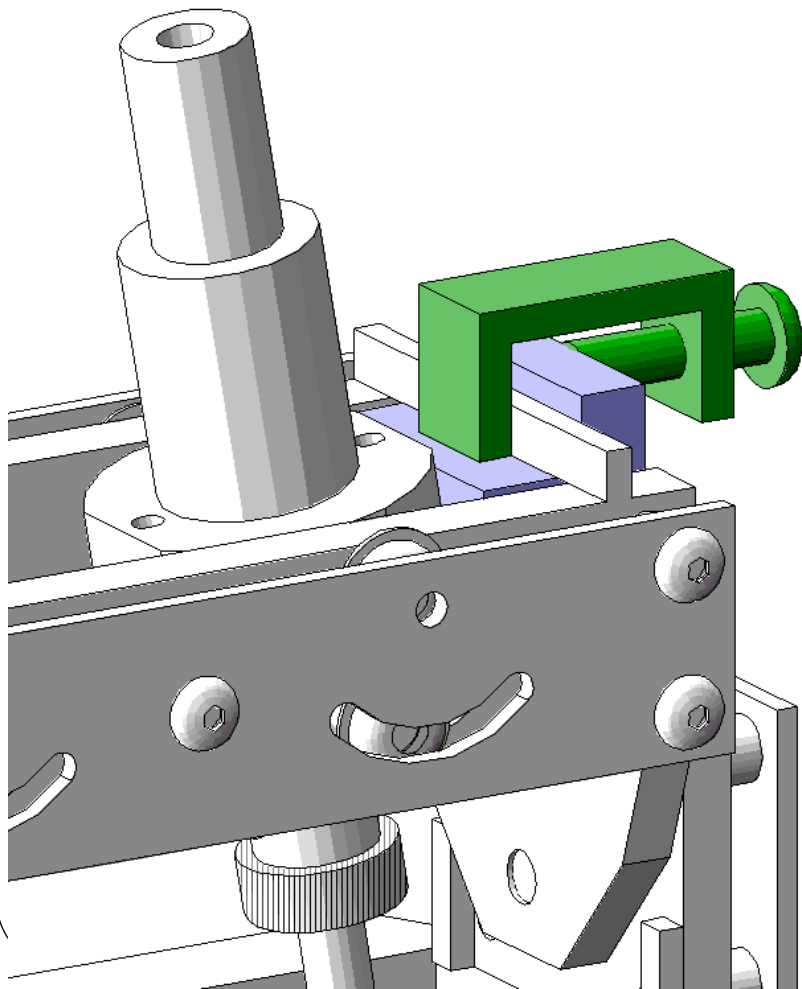

# Module Rotation 28 Degrees

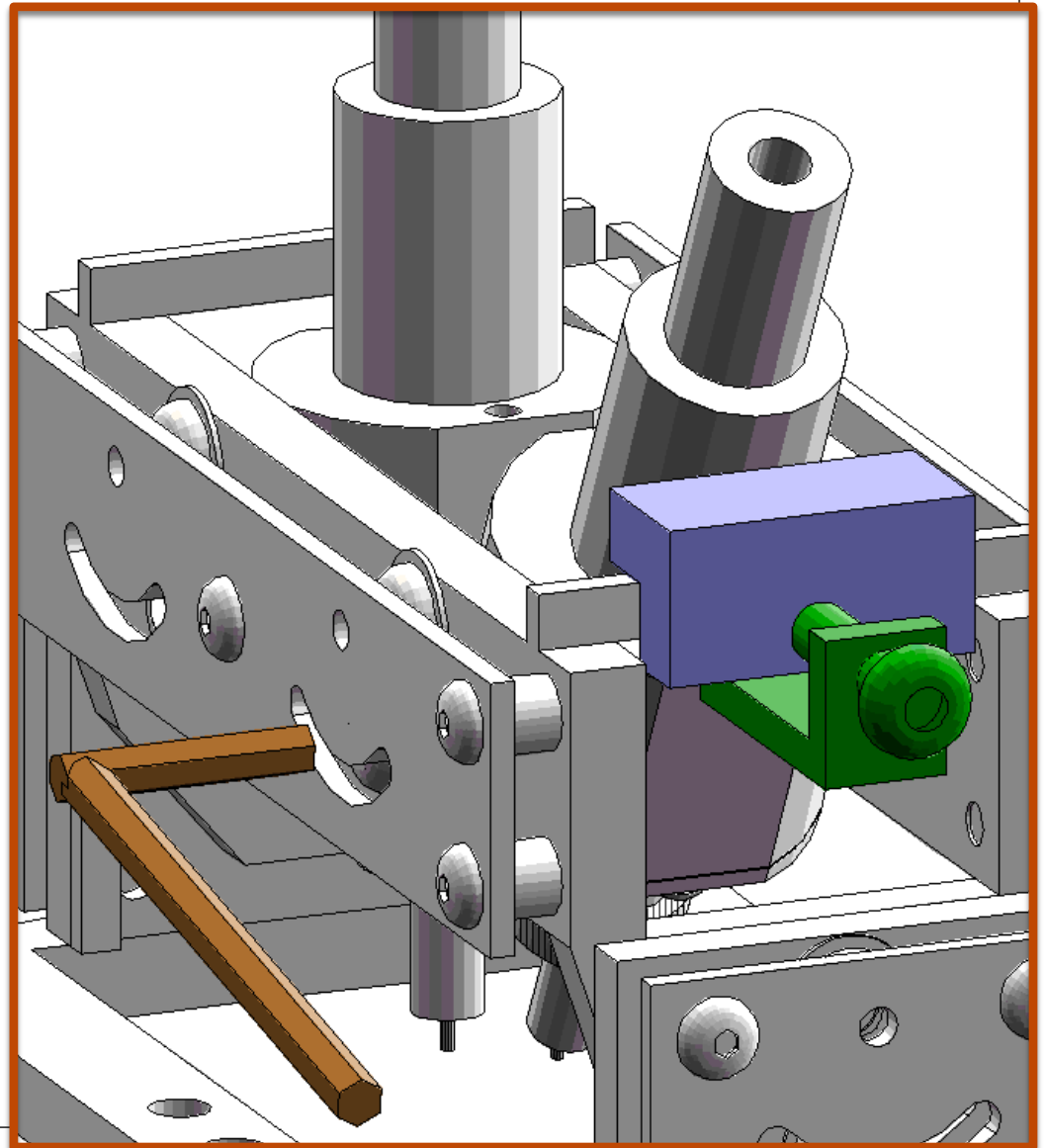
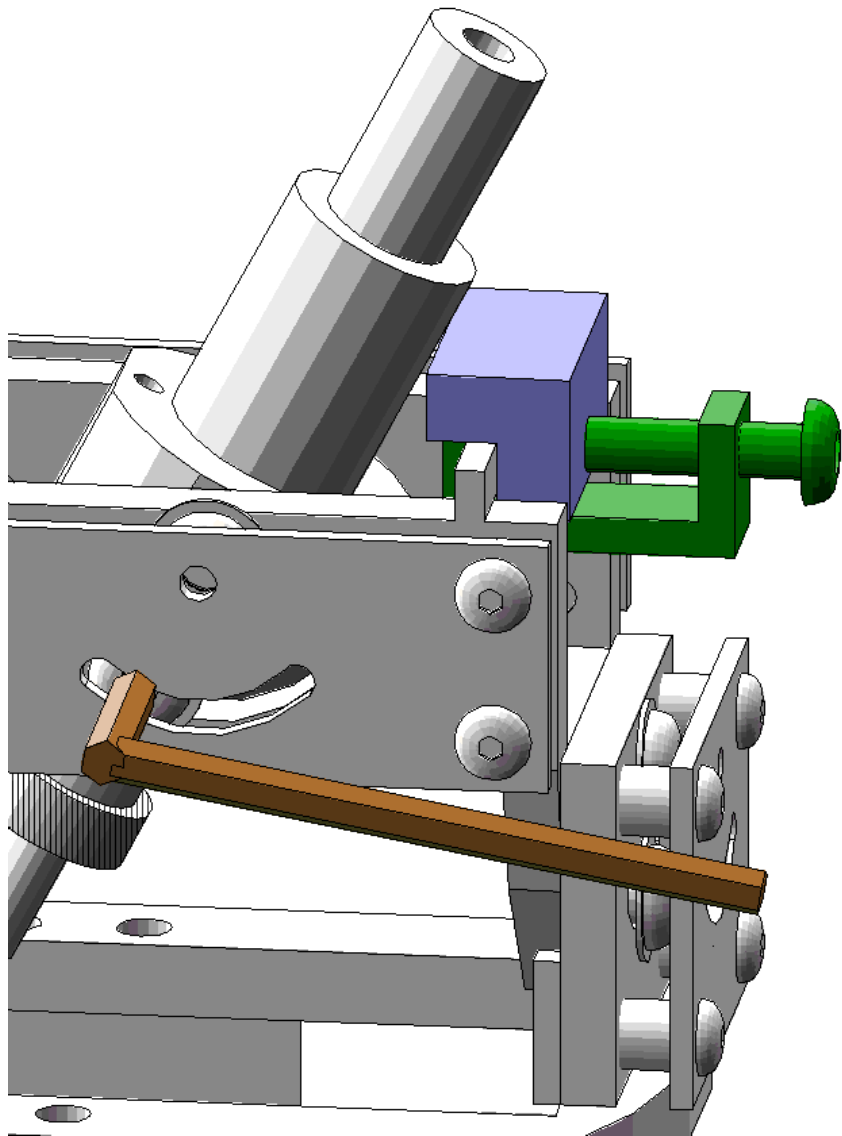

# Mount Rotation Range

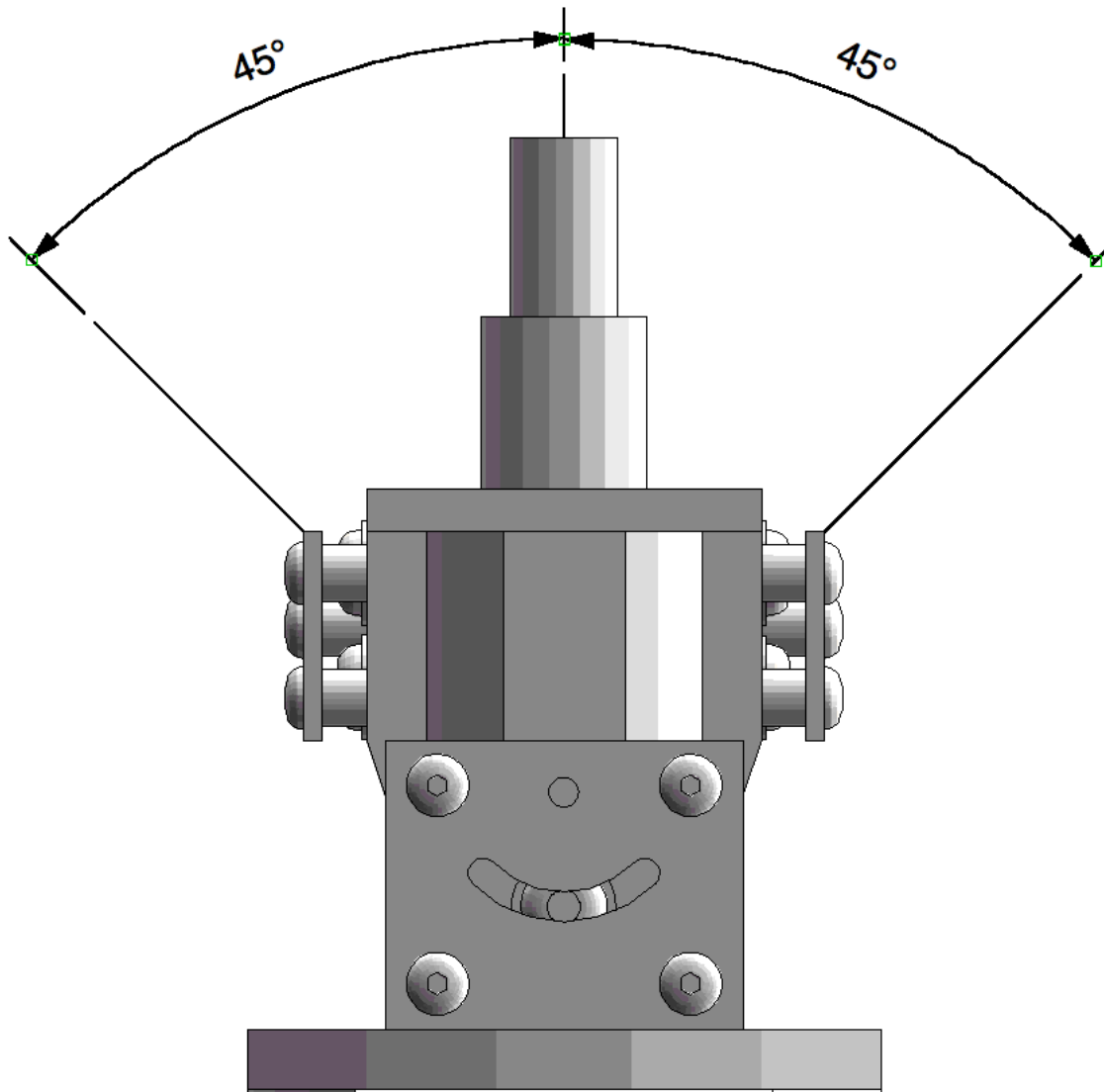



# Mount Rotation

- Angleblock is secured to physical barrier on mount with clamp
- Allen key is then used to loosen mount so it can rest against angleblock (here 28 degrees)
- Allen key is used to secure mount
- Clamp is removed and angleblock slides out

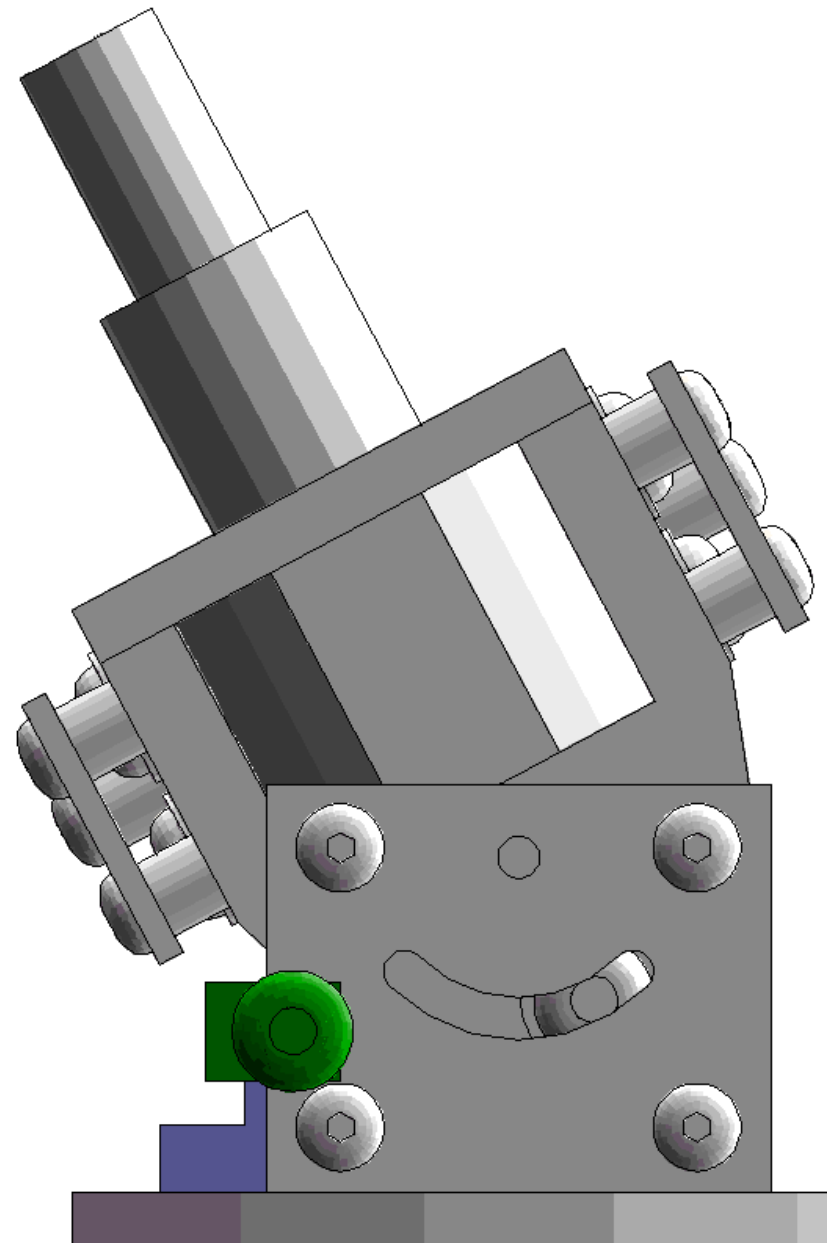

# Mount Rotation

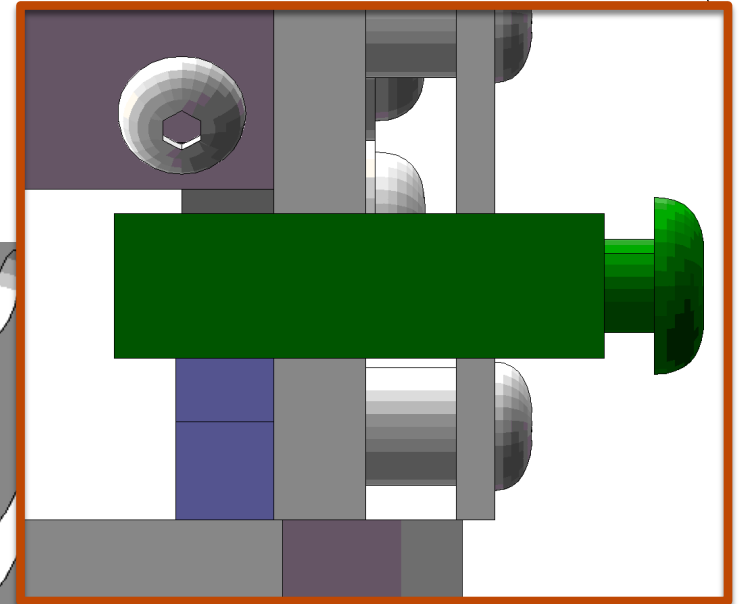
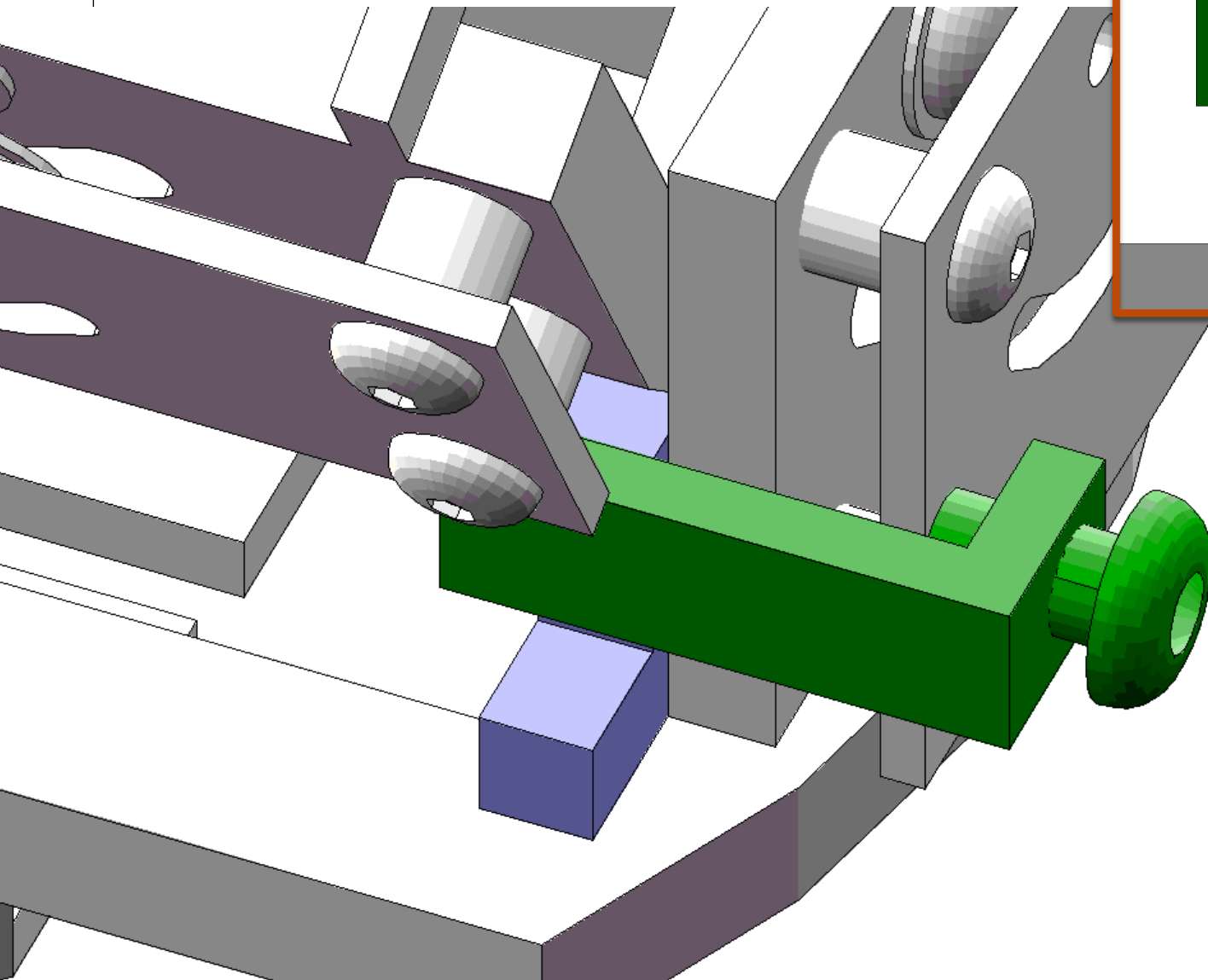

# Mount Rotation

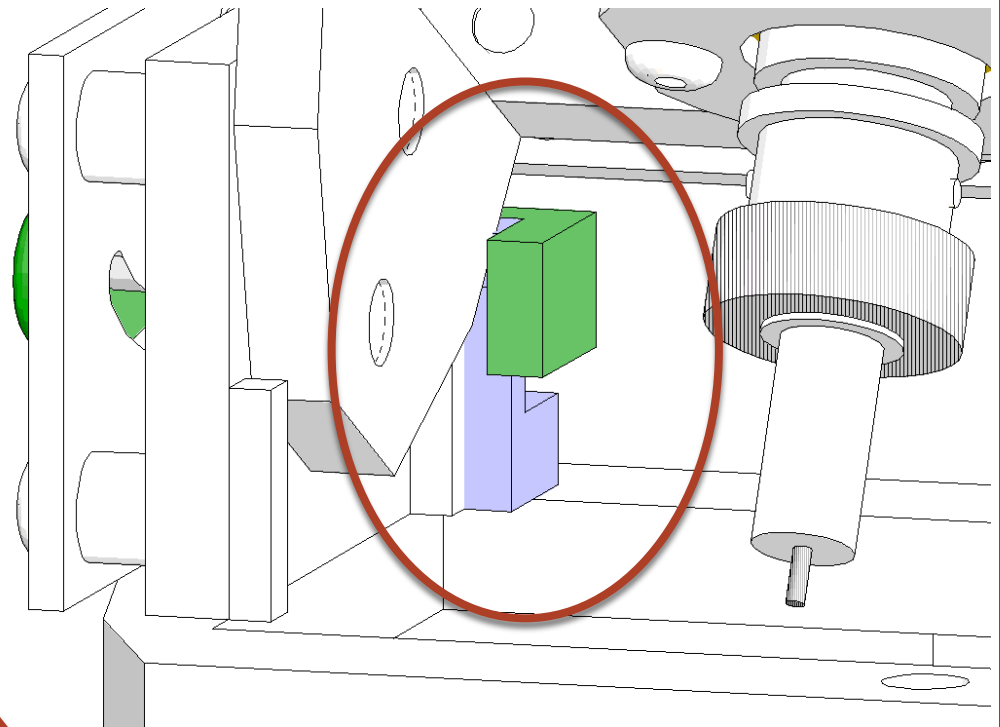
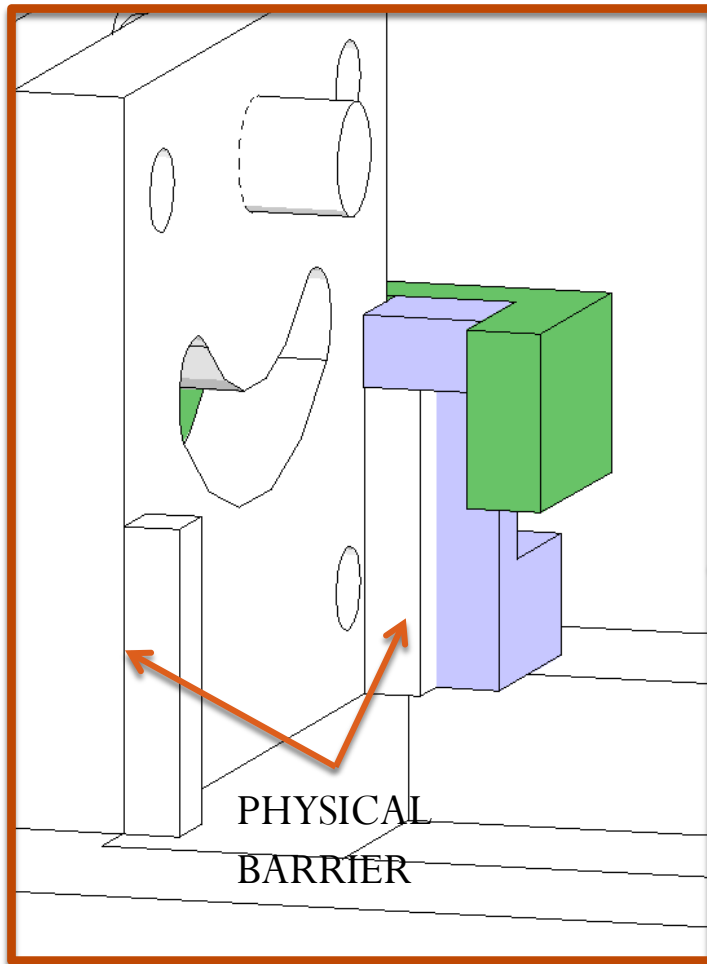

A VIEW WITH MOUNT 1 REMOVED  
TO SEE CLAMP SECURING  
ANGLEBLOCK TO PHYSICAL BARRIER  
ON MOUNT 2